

New brushless motors for small airplanes OMA-3815-1000 (15 class) OMA-3810-1050 (10 class)

These two are new addition to the four already available O.S. brushless motors which are well received for high quality and high performance. Total six size motors offer wider options which cover from 4 stroke 90 size to two stroke 10 size models.

FEATURES OF O.S. OMA SERIES BRUSHLESS MOTORS

- Unique cooling system increases efficiency and keeps the performance.
- A thick can design and big bearings ensure high durability and efficiency.
- A high precision stainless propeller shaft (adapter assembly) is supplied.



		OMA-3810-1050	OMA-3815-1000
Outer diameter	mm	φ 37.0	φ 37.0
Body length	mm	32.8	37.8
Poles		14	14
Shaft diameter	mm	φ 4	φ 5
Shaft length	mm	11.7	11.7
Weight	g	102	130
Lead wire length	mm	50	50
Lead wire gauge		17AWG	17AWG
Male connector	mm	φ 3.5	φ 3.5
Rated voltage	V	11.1	11.1
Rated current	A	30	35
Maximum current	A	50A 5秒	60A 5秒
No-load current	A	1.1	1.1
Phase resistance	mΩ	51.3	36.5
Phase inductance	μH	31.6	23.8
Maximum efficiency	%	85	85
KV	rpm/V	1050	1000
Turns	T	22	16

Propeller Data Chart

The propeller data shown are examples using APC propellers. LiPo batteries used cell number is shown. The data are for just reference and vary according to various conditions. Be sure to check the current actually measuring with a measuring instrument. Also, be sure to use the motor within the acceptable range of the ESC as well as LiPo batteries.

OMA-3810-1050							
Propeller (DxP)	LiPo	Voltage	ESC	Current	Wattage	Thrust	R.P.M.
9x6SF	3Cell	12.6V	50A	40A	504W	1.0kg	9,150
9x6E	3Cell	12.6V	50A	25A	315W	1.1kg	10,750
9x7.5E	3Cell	12.6V	50A	30A	378W	1.3kg	10,250
10x3.8SF	3Cell	12.6V	50A	37A	466W	1.0kg	9,500
10x4.7SF	3Cell	12.6V	50A	37A	466W	1.2kg	9,550
10x5E	3Cell	12.6V	50A	26A	328W	1.3kg	10,650
10x7SF	3Cell	12.6V	60A	52A	655W	1.3kg	8,000
10x7E	3Cell	12.6V	50A	34A	428W	1.6kg	9,850
11x3.8SF	3Cell	12.6V	50A	41A	517W	1.2kg	9,000
11x4.7SF	3Cell	12.6V	50A	45A	567W	1.3kg	8,500
11x5.5E	3Cell	12.6V	50A	33A	416W	1.6kg	9,900
11x7SF	3Cell	12.6V	60A	55A	693W	1.4kg	7,200
11x7E	3Cell	12.6V	50A	40A	504W	1.8kg	9,200
11x10E	3Cell	12.6V	60A	50A	630W	2.0kg	8,150

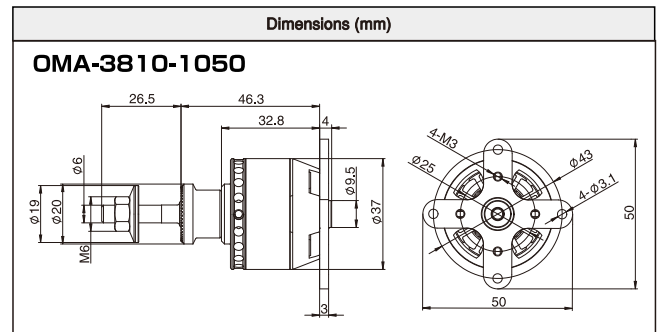

*SF: For electric slow flight
E: For electric

OMA-3815-1000							
Propeller (DxP)	LiPo	Voltage	ESC	Current	Wattage	Thrust	R.P.M.
9x6SF	3Cell	12.6V	50A	40A	504W	1.1kg	9,350
9x6E	3Cell	12.6V	50A	25A	315W	1.1kg	10,500
9x7.5E	3Cell	12.6V	50A	30A	378W	1.3kg	10,250
10x3.8SF	3Cell	12.6V	50A	37A	466W	1.0kg	9,700
10x4.7SF	3Cell	12.6V	50A	37A	466W	1.2kg	9,700
10x5E	3Cell	12.6V	50A	26A	328W	1.3kg	10,500
10x7SF	3Cell	12.6V	60A	52A	655W	1.4kg	8,300
10x7E	3Cell	12.6V	50A	34A	428W	1.6kg	9,900
11x3.8SF	3Cell	12.6V	50A	41A	517W	1.2kg	9,300
11x4.7SF	3Cell	12.6V	50A	45A	567W	1.4kg	9,000
11x5.5E	3Cell	12.6V	50A	33A	416W	1.7kg	9,900
11x7SF	3Cell	12.6V	60A	55A	693W	1.6kg	7,800
11x7E	3Cell	12.6V	50A	40A	504W	1.9kg	9,500
11x10E	3Cell	12.6V	60A	50A	630W	2.3kg	8,600
12x3.8SF	3Cell	12.6V	60A	55A	693W	1.2kg	8,100
12x6SF	3Cell	12.6V	70A	64A	806W	1.6kg	7,300

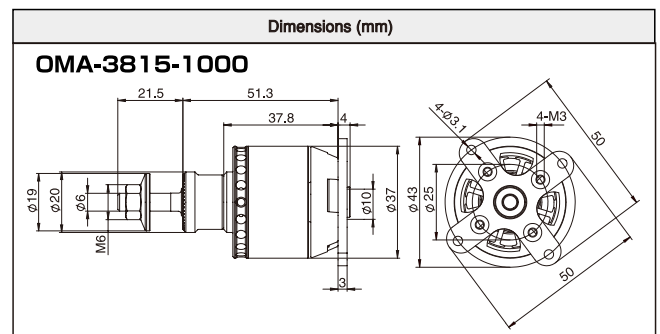

*SF: For electric slow flight
E: For electric