

# GT33REU

Three views (mm)

**O.S.**  
PROFESSIONAL

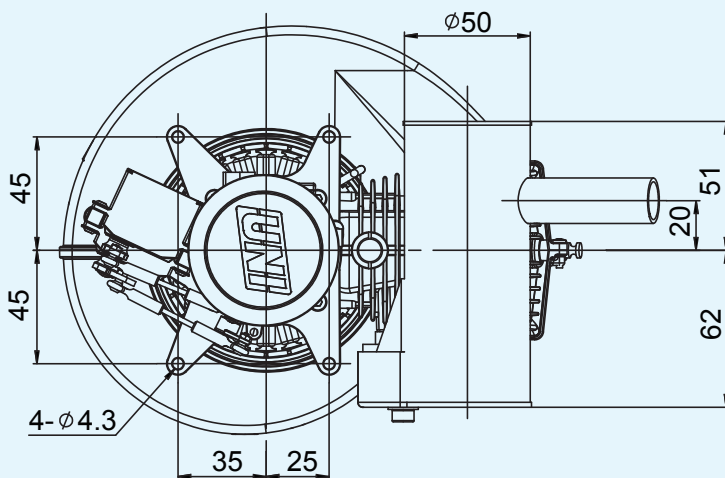
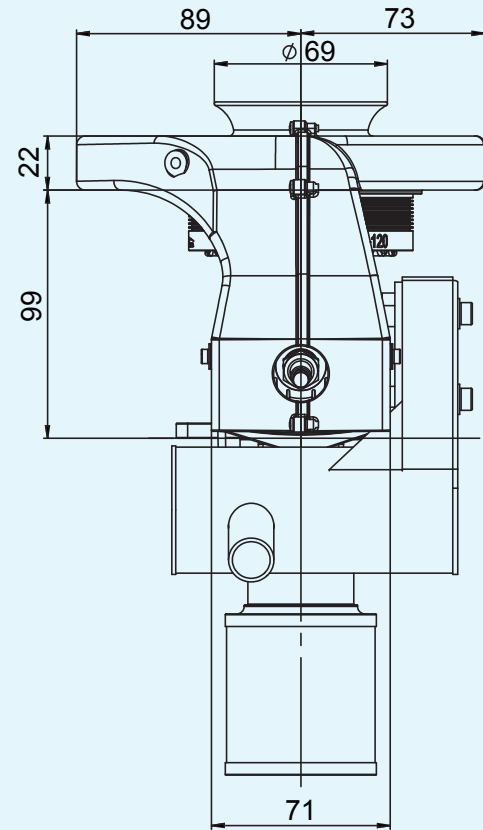
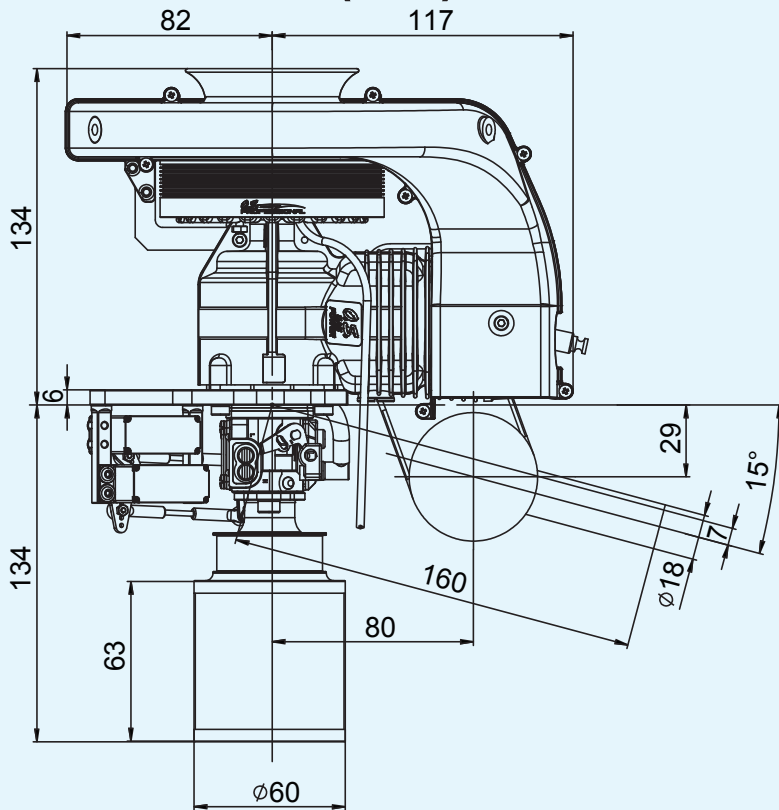

## SPECIFICATIONS

MODEL	GT33REU
USAGE	range extender for drone
CONSTANT OUTPUT RATING	1.0kw
VOLTAGE	48V
WEIGHT	2,530g (body 2,200g, accessories 330g)
STARTING METHOD	by a built-in starter motor
FUEL	Mixed gasoline with 2-stroke oil
FUEL CONSUMTION	720cc/0.7kw · h ~ 1,480cc/1.4kw · h
FUEL CONSUMTION RATE	790g/kw · h (rated)
TYPE OF ENGINE	air-cooled, 2-stroke, reciprocating single cylinder engine
DISPLACEMENT (BORExSTROKE)	33cc (36 x 32.4mm)
CARBURETOR	diaphragm type, Walbro WT
SPARK PLUG	M 10mm (NGK CM-6 type)
OPERATING ENVIRONMENT	atomospheric temperature: -20 ~ 50°C, altitude: 0 ~ 3,000m
ENDURANCE TIME	Approx. 500 hours (overhauling every 100 hour operation)

The specifications are subject to alteration for improvement without notice.