

Thank you for purchasing the U2S-1.

The U2S-1 is a USB interface for communications between Link-supported devices (such as a S.BUS servo, Gyro and ESC) and Windows computer.

Notes

- Please read this manual thoroughly before using your U2S-1.
- Store this manual in a safe place where it can be accessed at any time.

* A PC-LINK adapter (extension cord) is supplied with the U2S-1.

- Reproduction of all, or part, of the contents of this manual without prior written permission is prohibited.
- The contents of this manual are subject to change without prior notice.
- The contents of this manual should be complete. ; Please contact us if you find errors or points that are unclear.
- O.S. will not be responsible for the results of use of devices by the customer.

Specifications

(Specifications and ratings are subject to change without prior notice accompanying technological developments.)

- Interface: USB Rev2.0 compliant
- USB connector: USB Series A connector
- Operating voltage: 5.0V ±0.2V (USB bus power)
- Current drain (At connection, idle): 5.8 ±1.7mA
- Operating environment: Temperature -10 ~ +45°C
- Dimensions: 18.2 x 56.5 x 9.0 mm
- Weight: 7.5g
- Applicable OS: Windows Vista/7/8/8.1/10

*The PC must have a USB port (Type A).

Link programs must be installed.

- For communication and setting, Link programs corresponding to each device must be installed. Install the Link programs from the O.S.ENGINES homepage(<http://www.os-engines.co.jp/dll/air>) on your PC. The method is described on the homepage.

Connecting and disconnecting the PC and U2S-1

Connection

- *Make sure that your PC is connected the internet.
- *Please update Windows before connecting the U2S-1 to the PC.
- *To use the U2S-1, driver software must be installed.
- *When using the U2S-1, please disconnect the other USB Serial Port devices from the USB port on your PC.

1. Turn on the PC power.
2. Connect the U2S-1 to the USB port of the PC.
3. Once the U2S-1 is connected to the PC, download the recommended driver software automatically. Using Windows Vista, the "Found New Hardware Wizard" window appears on the screen. Click "Locate and install driver software".

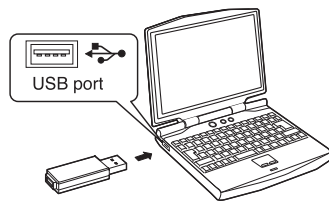

Disconnection

The U2S-1 can be disconnected from PC even while the Power is on. However, the U2S-1 should not be disconnected while it is communicating with a Link-supported device.

Example of connection to Link programs supported device

(The figure below is an example of connection to an EM-100.)

When using the U2S-1, please disconnect the other USB Serial Port device from the USB port on your PC.

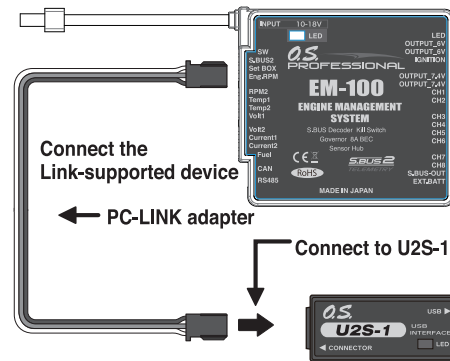

Connection method

1. Connect the U2S-1 to the USB port of the PC.
2. Connect the Link-supported device to the U2S-1.
4. Set the power switch of the Link device to ON.
5. Communication with the Link program is possible.

Usage Precautions

WARNING

- ⊘ Do not disassemble the U2S-1. Do not open the U2S-1 case. Opening the case may damage the PC board. In this case, PC assembly replacement or repair will become impossible. There is also the danger of fire and electric shock.
- ⊘ Do not expose the U2S-1 to water or other liquids. Do not touch the U2S-1 when your hands are wet. Water droplets entering the U2S-1 may cause trouble. There is also the danger of fire and electric shock.

CAUTION

- ⊘ Do not drop or expose the U2S-1 to strong shock. It may cause trouble.
- ⊘ Do not set anything on top of the U2S-1. It may cause trouble.
- ⊘ Do not touch the connectors with your hands. Also, do not connect a dusty or dirty connector. It may cause trouble.
- Ⓜ Handle the PC and peripheral devices in accordance with the instruction manual and cautions and warnings given in the instruction manual of each product.

Special Markings

For safety's sake, pay special attention whenever you see the marks shown here.

- Symbol: ⊘ : Prohibited
- Ⓜ : Mandatory

Mark	Meaning
⚠ WARNING	Procedures which may lead to a dangerous condition or cause death or serious injury to the user if not carried out properly, or procedures where the probability of superficial injury or physical damage is high.
⚠ CAUTION	Procedures where the possibility of serious injury to the user is small, but there is a danger of injury, or physical damage, if not carried out properly.

*Windows is registered trademark of Microsoft Corporation.

<When requesting repair>

Reread manual before requesting a repair. If the problem continues, contact e-info@os-engines.co.jp