

MAX-21VZ-B V-Spec

(13890)

TYPE 21C

(23818050)

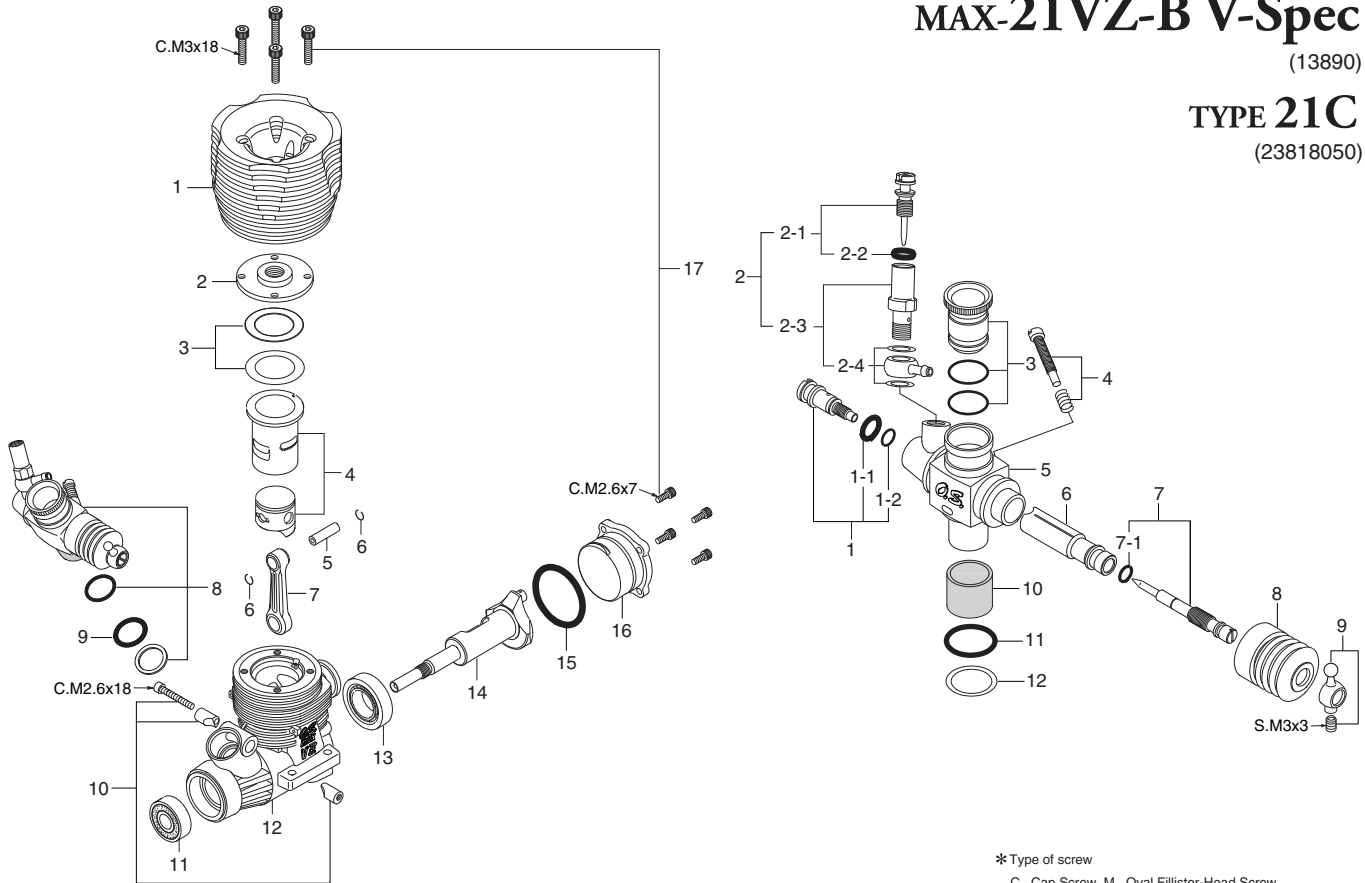

* Type of screw

C...Cap Screw M...Oval Fillister-Head Screw

F...Flat Head Screw N...Round Head Screw S...Set Screw

No.	Code No.	Description
1	22105000	Outer Head
2	22105100	Inner Head
3	23764010	Head Gasket (2pcs.)
4	22103010	Cylinder & Piston Assembly
5	23906000	Piston Pin
6	23817000	Piston Pin Retainer (2pcs.)
7	23755000	Connecting Rod
8	23818050	Carburetor Complete (Type 21C)
9	23715000	Carburetor Sealing Gasket
10	23981700	Carburetor Retainer Assembly
11	23731000	Crankshaft Ball Bearing (Front)
12	23751010	Crankcase
13	23730010	Crankshaft Ball Bearing (Rear)
14	22102000	Crankshaft
15	23764020	Cover Gasket
16	23757000	Cover Plate
17	23763010	Screw Set
	71641300	Glow Plug T-P3
	22826140	Exhaust Seal Ring
	71533000	Carburetor Reducer 8mm (RED) w/ "O" Ring (2pcs.)
	22884250	Dust Cap Set (3mm,16mm,18mm)

No.	Code No.	Description
1	23781600	Mixture Control Valve Assembly
1-1	46066319	"O" Ring (L) (2pcs.)
1-2	22781800	"O" Ring (S) (2pcs.)
2	23618190	Needle Valve Assembly
2-1	23618197	Needle Assembly
2-2	46066319	"O" Ring (2pcs.)
2-3	23618194	Needle Holder Assembly
2-4	23818176	Fuel Inlet (No.9)
3	71533010	Carburetor Reducer 9mm (BLUE) w/ "O" Ring (2pcs.)
4	23818500	Throttle Stop Screw
5	23818130	Carburetor Body (w/Thermo Insulator)
6	23781200	Slide Valve
7	23818340	Metering Needle Assembly
7-1	27881820	"O" Ring (2pcs.)
8	22884220	Dust Cover
9	23781400	Ball Link No.3
10	23781110	Thermo Insulator
11	29015019	Carburetor Rubber Gasket
12	23818190	Carburetor Sealing Washer

O.S. GENUINE PARTS & ACCESSORIES

Code No.	Description
72106150	T-2050 Exhaust Header Pipe Assembly
72106060	T-2050 Tuned Silencer Assembly
72106070	T-2050 Tuned Silencer Complete Set
72413000	Super Air Cleaner 203 Assembly (W/2 filter elements)
72413200	203 Filter Elements (4pcs.)
71530200	Crankshaft Clamp 1521
22826140	Exhaust Seal Ring (2pcs.)
73300305	Dust Cap Set 3mm (5pcs.) (for Carburetor Nipple)
73300812	Dust Cap Set 8mm (3pcs.) (for Tuned Silencer)
73301612	Dust Cap Set 16mm (3pcs.) (for Carburetor)
73301812	Dust Cap Set 18mm (3pcs.) (for Exhaust)
79871020	M2.6x7 Cap Screw Set (10pcs.)
79871055	M2.6x18 Cap Screw Set (10pcs.)
71521000	Long Socket Wrench With Plug Grip